

APPROVED
June 23, 2025
**BOARD OF RECREATION
AND PARK COMMISSIONERS**

BOARD REPORT

NO. 25-108

DATE June 23, 2025

C.D. 14

BOARD OF RECREATION AND PARK COMMISSIONERS

SUBJECT: 6TH STREET PARK, ARTS, AND RIVER CONNECTIVITY (PARC) PROJECT –
CONCEPTUAL APPROVAL OF THE NAMING OF THE PARC SOCCER FIELD,
INSTALLATION OF A FACILITY SIGN REFLECTING THE PROPOSED NAME,
AND INSTALLATION OF PROPOSED DONOR RECOGNITION SIGNAGE AT
THE FIELD

* B. Aguirre	<u>BA</u>	M. Rudnick	<u> </u>
C. Stoneham	<u> </u>	C. Santo Domingo	<u> </u>
B. Jones	<u> </u>	N. Williams	<u> </u>



General Manager

Approved X Disapproved Withdrawn

RECOMMENDATIONS

1. Conceptually approve the naming of the soccer field at the PARC Project (Field) as “Tommy’s Field – Boyle Heights” in accordance with the RAP Naming Policy and the installation of a facility sign reflecting said name, subject to the Board’s final approval at a later date;
2. Conceptually approve the installation of proposed recognition signage in accordance with the RAP Sponsorship Recognition Policy, as depicted by the sample signage renderings included in Attachment 1 of this Report (collectively, “Recognition”), subject to the Board’s final approval at a later date, of the proposed final signage renderings which will include the names of the actual donors who have and/or will contribute to the development of the Field as part of the PARC Project; and
3. Authorize RAP staff to make technical corrections in order to carry out the intent of the Board in approving this Report.

SUMMARY

The 6th Street Viaduct Park, Arts, and River Connectivity Project (PARC Project) is a park development project currently underway in the City Council’s 14th District (CD14), under the oversight and management of the Department of Public Works, Bureau of Engineering (BOE), which was previously considered and approved by the Board. As illustrated by the Conceptual Project Rendering included with this Report as Attachment 2, the PARC Project encompasses three areas: the “East Park” on the Boyle Heights side of the 6th Street Bridge (Bridge), which will

BOARD REPORT

PG. 2 NO. 25-108

include various active and passive recreational amenities and features; the “Arts & River Gateway” located directly below the Viaduct at Santa Fe Avenue and Mesquit Street in the Arts District, which will include an arts plaza with performance areas with terrace seating, as well as a garden; and the “West Park” located at 6th and Mateo Streets, which will include a rain garden, lay and performance lawns, a dog park, café and restrooms, and fitness equipment area.

The focus of this Report is the soccer field at the PARC Project (Field) being constructed directly underneath the Bridge within the East Park portion of the PARC Project. The Department of Recreation and Parks (RAP) does not currently have any jurisdiction over the PARC Project or the underlying properties. As discussed at previous Board meetings where various aspects of the PARC Project were considered, the BOE is currently responsible for the construction and delivery of the completed PARC Project. RAP will assume responsibility over the East Park portion through a comprehensive memorandum of understanding (MOU) stipulating the terms and conditions for the operation and maintenance of East Park by RAP; this MOU will be presented to the Board of Recreation and Park Commissioners (Board) for approval at a future meeting.

The TM23 Foundation (TM23) is a 501(c)(3) public benefit California non-profit corporation with a mission to develop and support initiatives that inspire children and young adults to play, pursue their dreams, be themselves, and have a positive impact on their community. TM23 was created by Doug and Nikki Mark in honor of their deceased son Tommy, who passed away in his sleep one month shy of his thirteenth birthday due to unknown causes. Previously, TM23 funded the development of “Tommy’s Field” at Westwood Recreation Center in 2020 through an agreement with RAP and the Los Angeles Parks Foundation (LAPF) stipulating the terms and conditions for the use of a \$1.2 million dollar donation from TM23 to RAP through the LAPF (Report Nos. 20-001 and 21-174). A second “Tommy’s Field” opened in 2023 at Vista Del Mar School in West Los Angeles. TM23 has again offered to support RAP, City of Los Angeles youth, and the Boyle Heights community, through a donation to the BOE in an amount up to \$1.5 million dollars (Donation) specified for use towards the completion of the East Park Field as the third “Tommy’s Field” in the City of Los Angeles.

Through a CD14-sponsored Council Motion (CF 24-0874), the BOE has been authorized to accept the donation from TM23 to fund the East Park Field in honor of Tommy Mark. The BOE, through its Board of Public Works, will accept the Donation through a gift agreement between the BOE and TM23, which will specify that the funds be used only towards the construction of the Field. In appreciation of TM23’s generous Donation, RAP has agreed to coordinate with the BOE regarding the naming of the Field as “Tommy’s Field – Boyle Heights”, the installation of a facility sign reflecting said name, and installation of the Recognition described herein once approved by the Board, in the form similar to that which is illustrated by the sample renderings included in Attachment 1 of this Report.

Staff will return to the Board at a later date for final approval of the naming of the Field, the installation of a facility sign reflecting said name, and the installation of Recognition including the names of the actual donors who have provided donations to TM23 in support of the Field’s completion. At such time, Staff will also request the following:

BOARD REPORT

PG. 3 NO. 25-108

- The Board's authorization to allow the BOE to install the approved Recognition at a designated location approved by RAP within the vicinity of the Field, in appreciation and recognition of the monetary contributions received by TM23 from various donors; and
- The Board's approval of an agreement with TM23 specifying the terms and conditions for the naming of the Field, installation of the Recognition, and schedule of Field use between RAP and TM23.

The immediate request – for the conceptual approvals described herein – will facilitate BOE staff's planning for the installation of related signage and further coordination with TM23 for the acceptance of the Donation, and also facilitate TM23's continuing fundraising efforts by demonstrating that such efforts are supported by the Board.

Staff recommends the conceptual approval of the naming of the Field as "Tommy's Field – Boyle Heights" and installation of the facility sign and sample Recognition included with this Report with the understanding that the such naming and installation are subject to the Board's final approval at a later date.

ENVIRONMENTAL IMPACT

The proposed Board action involves the conceptual approval of the naming of a City-owned soccer field and the installation of a facility sign and related sponsor recognition, which are all subject to the final approval of the Board at a later date; RAP staff will address the implications for the California Environmental Quality Act (CEQA) when the Board considers final approval of the such naming and installations.

FISCAL IMPACT

There is no fiscal impact to the RAP General Fund arising from the Board's conceptual approval of the naming of the Field, the installation of a facility sign reflecting said name, and the installation of the Recognition described herein, which are all subject to the final approval of the Board at a later date.

This Report was prepared by Joel Alvarez, Senior Management Analyst II, Partnership Section.

LIST OF ATTACHMENTS/EXHIBITS

- 1) Proposed Recognition
- 2) Conceptual PARC Project Rendering

Field Recognition

Sample Facility Sign: "Tommy's Field – Boyle Heights"



Donor Recognition Plaque Sample Mock-Up East Park Tommy's Field – Boyle Heights

<p>SOUTHERN CALIFORNIA BRONZE COMPANY <i>Since 1927</i></p>	<p>At Sterling, Nat. Projects Mngr. 949-305-0488 E: al@socalbronze.com C: 949-616-4617</p> <p>Corporate Offices - 337 W. Cerritos Ave., Glendale, CA 91204 P: 818-550-9132 Masters of Metal, Plastic, Glass & Wood for Dedication, Memorialization, Donor Recognition</p>																		
<div style="display: flex; justify-content: space-around; align-items: flex-start;"> <div style="text-align: center;"> <p>30" x 42"</p> </div> <div style="text-align: center;"> <p>1/2" x 1/2" x 1/2"</p> </div> <div style="text-align: center;"> <p>30" x 42"</p> </div> </div> <table border="1" style="margin-top: 10px; width: 100%; font-size: 0.8em;"> <tr> <td>Prod. & Mat.</td> <td>Cast Bronze</td> </tr> <tr> <td>Plating Item</td> <td>10.0% A, 10.0% B, 10.0% C</td> </tr> <tr> <td>Border Style</td> <td>Single Line per artwork</td> </tr> <tr> <td>Background</td> <td>Leatherette</td> </tr> <tr> <td>Mounting</td> <td>Painted Dark Gold</td> </tr> <tr> <td>Finishing</td> <td>Brushed satin finish, hand grip</td> </tr> <tr> <td>Mounting Type</td> <td>Box & Stud - Blind Mt. (hardwood suggested)</td> </tr> <tr> <td>Clearcoat</td> <td>Exterior High-Durability Clear coat</td> </tr> <tr> <td>Notes</td> <td></td> </tr> </table>		Prod. & Mat.	Cast Bronze	Plating Item	10.0% A, 10.0% B, 10.0% C	Border Style	Single Line per artwork	Background	Leatherette	Mounting	Painted Dark Gold	Finishing	Brushed satin finish, hand grip	Mounting Type	Box & Stud - Blind Mt. (hardwood suggested)	Clearcoat	Exterior High-Durability Clear coat	Notes	
Prod. & Mat.	Cast Bronze																		
Plating Item	10.0% A, 10.0% B, 10.0% C																		
Border Style	Single Line per artwork																		
Background	Leatherette																		
Mounting	Painted Dark Gold																		
Finishing	Brushed satin finish, hand grip																		
Mounting Type	Box & Stud - Blind Mt. (hardwood suggested)																		
Clearcoat	Exterior High-Durability Clear coat																		
Notes																			
<p>CLIENT CONTACT INFORMATION</p> <p>Nikki Mark 323-829-8300 nikfreemark@gmail.com</p> <p>REFERENCE GRAPHICS</p>	<p>Ver. A Date Drawing L.A. tm3.ded tmx major donors v1 08 19 24</p> <p>v01 08 19 24 PRELIMINARY DRAWING only. Per client supplied information</p> <p>v02 xx xx 24</p> <p>v03 xx xx 24</p> <div style="text-align: center;"> <p>FRONT FACE 30" X 42"</p> </div>	<p>THIS DRAWING NOT APPROVED FOR PRODUCTION</p> <p><input type="checkbox"/> IF BOX HAS "RED X" THIS ARTPROOF INCLUDES A SCULPTED ELEMENTS AND THERE WILL BE TWO PROOFS: 1ST PROOF FOR LAYOUT AND 2ND PROOF FOR SCULPTING.</p> <p>CLIENT APPROVAL BELOW: MUST BE READ, SIGNED & DATED FOR APPROVAL</p> <p>I HAVE REVIEWED THIS ARTWORK AND THE DOCUMENT SPECIFICATIONS, INCLUDING ALL PROVIDED DOCUMENTS AND SAMPLE MATERIALS. PRIOR TO MY SIGNING AND DATING THE APPROVAL, I WILL REVIEW/EXECUTE ITEMS (1, 2, 3 and 4):</p> <p>① REVIEW TEXT AND GRAPHICS FOR GRAMMAR ② AGAIN REVIEW ALL SPECIFICATIONS, ASK SPELLING AND POSITIONING ATTITUDES SDCAL BRONZE IF YOU DON'T UNDERSTAND. I BY SIGNATURE AND DATE BELOW INDICATES THAT I AM ③ Email to: al@socalbronze.com APPROVING THIS ARTWORK FOR RELEASE TO PRODUCTION ④</p>																	

PARC Project and Field Conceptual Rendering

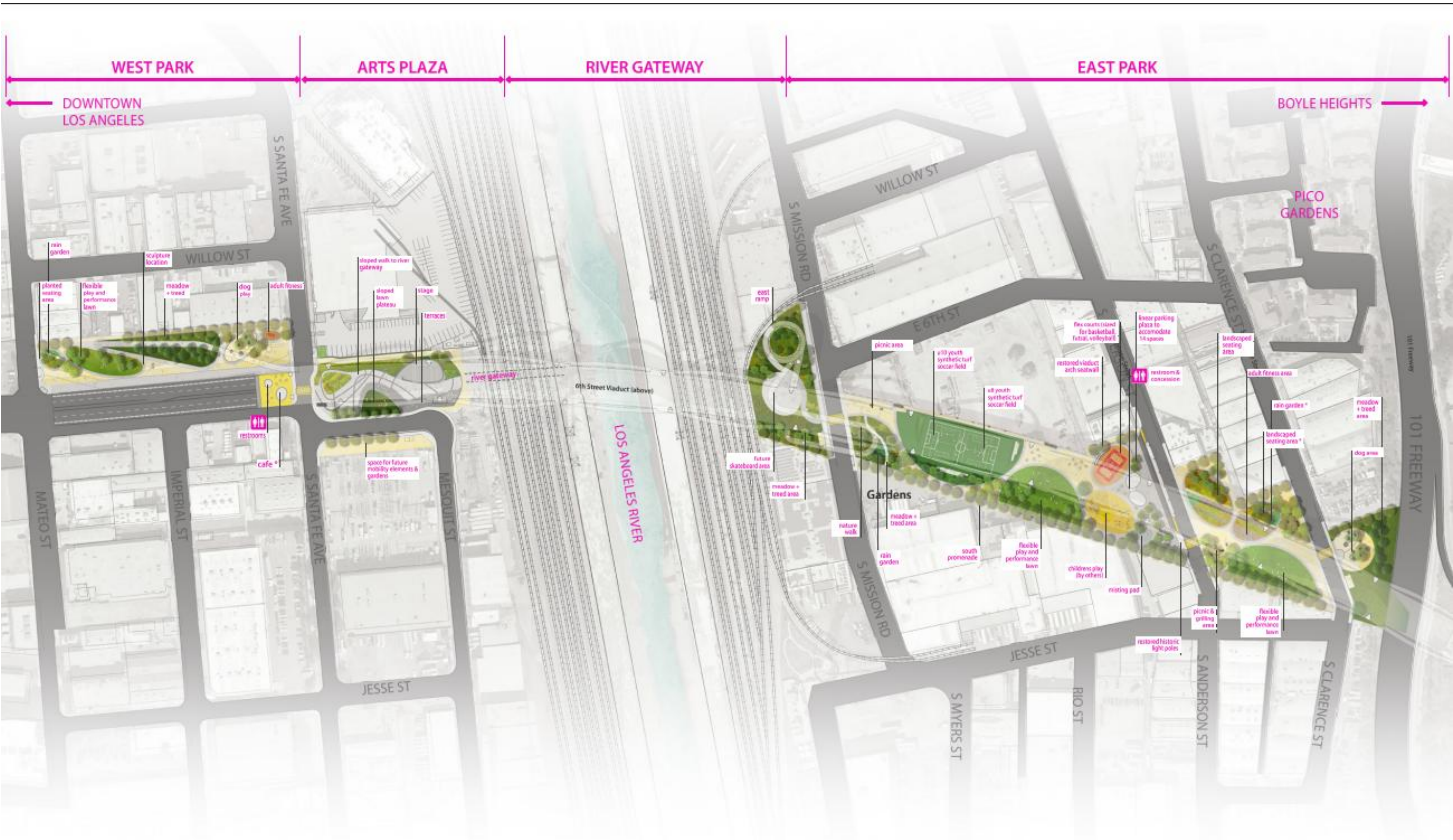

Site Plan

6th Street PARC
Council District 14 - Council member Kevin de León
Project of the Bureau of Engineering for Recreation and Parks

Hargreaves Jones



SYNTHETIC SOCCER FIELD